

PB-1200AC 12,000 mAh POWER BANK

Portable Power Bank with AC/USB Outlets

User Manual



Thank you for choosing Xcellon.

The Xcellon PB-1200AC is a versatile and portable charger that offers a wide variety of power and charging options when you're on the go. The Power Bank features USB and AC outputs and puts 12,000 mAh of power in your hands whenever you need it.

The USB output boasts 5 V and 2.4 A of power for quickly recharging smartphones, iPads, tablets, GoPro chargers, and other USB devices. The AC output can be used for charging laptop computers and camera batteries, but can also be used to power devices that draw up to 65 watts of power such as small desk fans, desk lamps (with 60 W bulbs), routers, printers, DVRs, and computer displays.

The Power Bank is fully charged in 3 hours and includes LED lights that indicate the battery's capacity. Intelligent microprocessor technology provides surge, overload, and short-circuit protection, as well as automatic shutdown in case of overheating. A universal AC plug adapter is included for international chargers.

Precautions

- ⚠ Do not use this unit around water or any flammable gases or liquids.
- ⚠ Keep fingers clear of contact with the prongs of the AC plug and AC outlet and use caution when inserting or removing the AC plug from an AC outlet. If the prongs of the AC plug are bent, they can become a shock hazard.
- ⚠ Some chargers for small NiCd batteries can be damaged if connected to the Power Bank. Do not use the Power Bank with devices that request a sine wave power source.
- ⚠ Do not connect live AC power to the Power Bank's AC outlet. This will damage the Power Bank.
- » Please read and follow these instructions, and keep this manual in a safe place.
- » Make sure that this product is intact and that there are no missing parts.
- » Use only the correct, recommended voltage.
- » Keep this product away from children.
- » All images are for illustrative purposes only.

Overview

Top

- 1 AC charging port

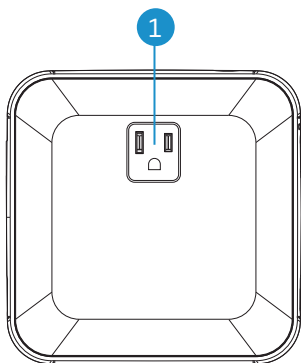

Side

- 2 USB charging port
3 USB indicator light
4 Charge indicator lights
5 Check/On button
6 AC switch
7 AC indicator light

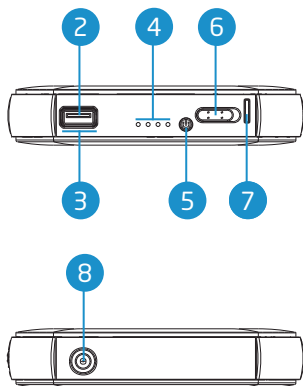

Rear

- 8 AC adapter input

Also Included

- 9 AC adapter
10 AC cable
11 Universal AC plug adapter
12 Carry pouch
13 User manual

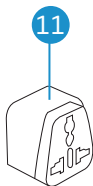
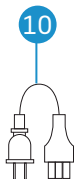
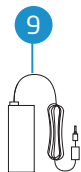

Charging the Power Bank

1. Use the included AC plug to connect the AC adapter to an outlet. Insert the plug of the adapter into the input port of the Power Bank.

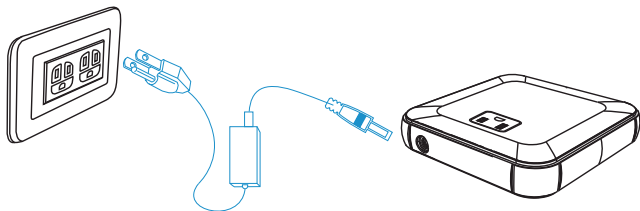

2. The indicator lights will blink to signify that the unit is charging. Four constant lights indicate the unit is fully charged.
3. Check the battery capacity of the Power Bank by pressing the Check button for 2 seconds. The lights will indicate the level of charge in the Power Bank. Each light signifies 25% capacity.



Note: If all four indicator lights are flashing, the input voltage is too low to charge the Power Bank.



Note: The Power Bank cannot charge a device when it is plugged into an AC outlet. When an AC outlet is connected to the input plug, the power to the USB output and the AC output are cut off.

Charging a Device Using the USB Output

The USB output port is capable of charging smartphones, iPads, tablets, GoPro chargers, and other USB-powered devices.

To charge a device using the USB output, follow these steps:

1. Plug the device into the USB output on the Power Bank.
2. Press and hold the On/Off button for 2 seconds. The indicator lights will illuminate to show the remaining charge in the Power Bank, and the blue LED in the USB output will glow to indicate that the device is charging. The indicator lights will turn off after 10 seconds.
3. When the device has fully charged, the Power Bank will automatically shut off.

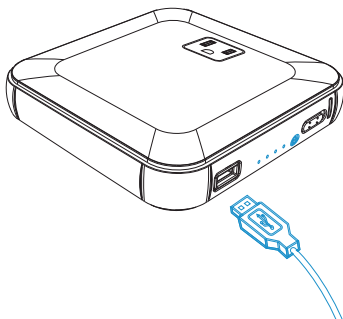

Note: To check the battery capacity while a USB device is charging, press the Check button.

Charging a Device Using the AC Output

The AC output is capable of charging devices such as laptop computers and camera or camcorder batteries, and it can power devices such as small desk fans, desk lamps with 60 W bulbs, routers, printers, DVRs, and computer displays.

! **Important:** Only devices that require less than 65 watts of power can be operated.

To charge or power a device using the AC output, follow these steps:

1. Plug the device into the Power Bank's AC Output.
2. Press and hold the On/Off button for 2 seconds. The indicator lights will illuminate to show the remaining charge in the Power Bank.
3. Move the AC Switch to the On position. The red LED will illuminate, indicating that the device is charging.
4. As the device charges, the battery capacity of the Power Bank drops. When the battery capacity gets too low, the Power Bank automatically shuts off to prevent damage to the battery.

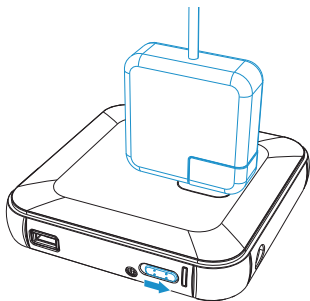

Using the Universal Plug Adapter

! **Important:** The Universal AC Plug Adapter is not a power converter and should not be used in that capacity.

1. Plug your device into the Universal Plug Adapter.
2. Plug the adapter into the Power Bank's AC output.
3. Proceed with the instructions under *Charging a Device using the AC Output* on page 7.

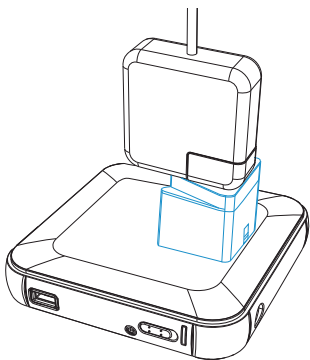

Troubleshooting

Problem	Solution
The Power Bank won't charge.	<ul style="list-style-type: none">• Make sure that the Power Bank is securely connected to the wall outlet.• Make sure you have properly connected the AC plug and power adapter to the Power Bank.
A USB device is plugged into the Power Bank but isn't charging.	<ul style="list-style-type: none">• Make sure the device is securely connected to the USB output.• Press the On/Off button to make sure that the battery has enough capacity remaining to charge the device.• The battery capacity of the Power Bank may be too low. Recharge the Power Bank.• Make sure the Power Bank is not connected to an AC outlet. When an AC outlet is connected to the input plug, the power to the USB and AC outputs is cut off.
A device is plugged into the AC output but isn't getting power.	<ul style="list-style-type: none">• Make sure the device is completely plugged into the Power Bank.• Make sure you have pressed the On/Off button and that the LED indicators are lit before you move the AC switch to the On position.• Make sure the Power Bank is not connected to an AC outlet. When an AC outlet is connected to the input plug, the power to the USB AC outputs are cut off.• Make sure the device does not draw more than 65 watts of power.
A device with a motor is plugged into the AC output but is not working.	<ul style="list-style-type: none">• Products that require a high-surge voltage or require a sine wave output should not be powered by the Power Bank.
The Power Bank suddenly shut down.	<ul style="list-style-type: none">• The battery is low and the Power Bank needs to be recharged.• The device being powered exceeds the surge capacity of the Power Bank.

Specifications

Dimensions (H × W × D)	1" × 5.1" × 5.1" (2.6 × 13 × 13 cm)
Weight	0.95 lb. (0.4 kg)
Capacity	12,000 mAh
Battery Type	Li-ion
Input	20 V DC/2 A (Max.)
Wave Form	Modified sine wave
Output Ports	USB, AC
USB Output	5 V DC/2.4 A (max.)
AC Output	120 V 60 Hz
Maximum Power Output	65 W
Operating Temperature	32°F-104°F (0°C-40°C)
Storage Temperature	14°F-140°F (-10°C-60°C)
Operating/Relative Humidity	5%-95% (noncondensing)

Safeguards

- » Overcharge protection with maximum voltage limited
- » Overheat protection with automatic shutdown
- » High/low-voltage protection with automatic shutdown
- » Short-circuit protection
- » Overdischarge protection
- » Overcurrent protection
- » Auto power off

One-Year Limited Warranty

This Xcellon product is warranted to the original purchaser to be free from defects in materials and workmanship under normal consumer use for a period of one (1) year from the original purchase date or thirty (30) days after replacement, whichever occurs later. The warranty provider's responsibility with respect to this limited warranty shall be limited solely to repair or replacement, at the provider's discretion, of any product that fails during normal use of this product in its intended manner and in its intended environment. Inoperability of the product or part(s) shall be determined by the warranty provider. If the product has been discontinued, the warranty provider reserves the right to replace it with a model of equivalent quality and function.

This warranty does not cover damage or defect caused by misuse, neglect, accident, alteration, abuse, improper installation or maintenance. EXCEPT AS PROVIDED HEREIN, THE WARRANTY PROVIDER MAKES NEITHER ANY EXPRESS WARRANTIES NOR ANY IMPLIED WARRANTIES, INCLUDING BUT NOT LIMITED TO ANY IMPLIED WARRANTY OF MERCHANTABILITY OR FITNESS FOR A PARTICULAR PURPOSE. This warranty provides you with specific legal rights, and you may also have additional rights that vary from state to state.

To obtain warranty coverage, contact the Xcellon Customer Service Department to obtain a return merchandise authorization ("RMA") number, and return the defective product to Xcellon along with the RMA number and proof of purchase. Shipment of the defective product is at the purchaser's own risk and expense.

For more information or to arrange service, visit www.xcellongear.com or call Customer Service at 212-594-2353.

Product warranty provided by the Gradus Group.

www.gradusgroup.com

Xcellon is a registered trademark of the Gradus Group.
© 2018 Gradus Group LLC. All Rights Reserved.

